

METRO® STARSYS™

We Put Lab Space to Work.™

INTRODUCING METRO STARSYS™

HERE TODAY . . .



. . . AND THERE TOMORROW



THE MOST ADAPTABLE, FLEXIBLE LABORATORY FURNITURE SYSTEM ON THE PLANET.

www.metro.com



Scientific Equipment &
Furniture Association Member



EMERSON
Storage Solutions

MOBILE WORKCENTERS

Reinvent your lab.
Modular, mobile,
highly-adaptive system,
enhances lab productivity
and space efficiency by empowering
the end user with the ability to
easily reconfigure and
move units around the lab.



The Starsys Modular System creates flexible space.

No matter what you need – open, closed, short, tall, stationary elements, preconfigured workcenters, mobile units – Starsys has the elements for you.

With Starsys, you choose from an array of modular units to fit the space and work specifications. It's that easy. And that flexible.

Starsys Benefits

- Facilitates fast, efficient lab installation.
- The ability to easily reconfigure lab furniture layout as needs change.
- The ability to easily reconfigure unit design.
- Flexibility to design a storage solution to exact needs.
- Corrosion-proof polymer components for a contamination-free product.
- Durable, easy-to-clean, polymer enclosures that won't chip, peel, dent, or rust — ever.
- Rigid aluminum and coated metal substructure, combined with advanced polymers, provides a robust, stable work environment for even the most sensitive equipment.
- A high level of organization.
- Easy access to supplies.
- Greater storage density in a smaller footprint.



Research Lab . . .

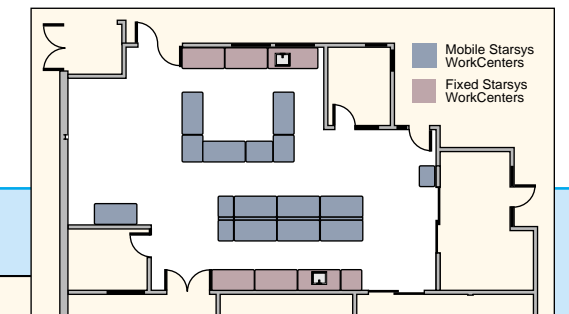

Research Lab, 15 minutes Later

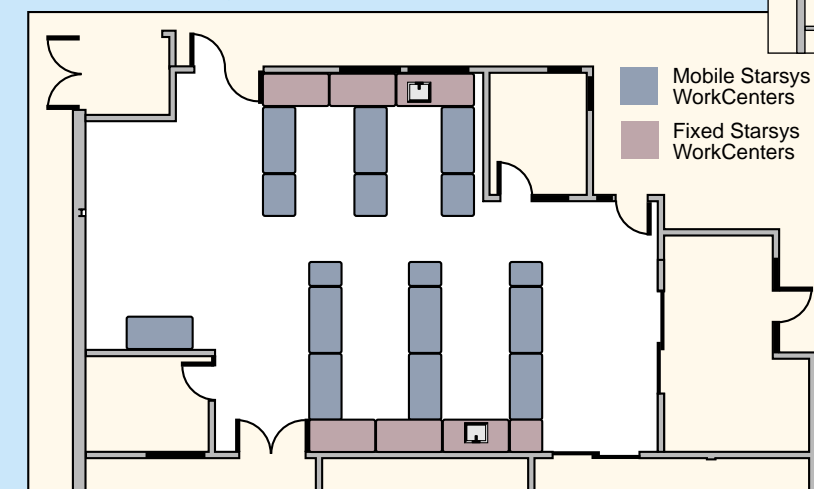

. . . or from another view. Look at how Starsys Mobile WorkCenters, when combined with fixed Starsys WorkCenters, can facilitate fast and easy lab reconfiguration.



HERE TODAY . . .

. . . AND THERE TOMORROW



Note: The Starsys System features advanced polymer materials that offer **excellent chemical resistance**. To obtain a complete **Starsys chemical resistance report**, please contact your local Metro representative.

MOBILE WORKCENTERS



A brief sampling of our entire
Mobile WorkCenters

product offering is shown.

To find out more information,
to view the entire selection
of available standard units, or to
design a unit
for your unique application, visit
www.starsysconfigurator.com



SXMWD36EOH3



SXMWTK36EOH2



SXMWT36EOH2



SXMWSK36EBS2



SXMWD36EBS2



SXMWTK36EBS2



SXMWT36EBS6

Note: Starsys Preconfigured Mobile WorkCenters feature epoxy-resin tops. Load rated at 900 lbs. (409kg).

Starsys innovation

comes in the form of a unique material construction. Interior extruded aluminum posts and robust steel frame provide strength and durability. Exterior advanced polymer shell is chip, dent, rust resistant and easy to clean. Starsys is built to last the test of time.



Epoxy-coated steel frame provides strength and durability.



Starsys extruded aluminum posts for strength and durability.

Weighted base eliminates tipping hazard.



Slide-in polymer back panel.
Polymer filler strip for aluminum post.
Slide-in polymer side panel.
Slotted Starsys post insert.

Overhead cabinets can be configured with polymer or wire shelves, depending upon application requirements.

Robust aluminum uprights provide secure mounting for overhead cabinets.

Epoxy worksurface rated at 900 lbs.

Advanced polymer shell is chip, dent, rust resistant and easy to clean.



BUILT FOR CHANGE

Overhead cabinet shelves are removable, easy-to-clean, and are available in both solid polymer and epoxy-coated, open-wire shelf designs.

Epoxy resin countertops come standard with Starsys mobile, pre-configured workcenter units. Other countertop materials such as stainless steel, colored laminates, phenolic, and hardwoods are also available on request.

Drawer pull is GMP compliant and can be accented with choice of 8 available colors.

Starsys drawer options include choice of polymer drawers (3", 4 1/2", 6", 7 1/2", 9", 10 1/2", and 12" heights) or heavy-duty drawers (3", 6", 9" and 12" heights), featuring stainless steel drawer interior, load-rated at 150 lbs. per drawer. Heavy-duty drawers are available in both single- and double-wide modules.

3" Total-Lock Caster: Utilize 3" total-lock plate casters for limited mobile applications or when additional storage area is required.



5" Total-Lock, All-Polymer Caster: Recommended for corrosive environments. All-polymer total-lock plate caster is an economical alternative to stainless casters.



Stabilizer/Leveling Caster: Recommended for applications where benchtop equipment demands unit stability and/or a level worksurface. Engage caster foot for stability, release for mobility.



Starsys mobile workcenter units can be specified with or without **overhead cabinets** attached. Available overhead heights include 24", 27", 30", 36" and 48".

Overhead cabinet accessories include light fixture, cassette bins for small item storage and organization, and poly shelf dividers.

Overhead cabinets can be specified with a variety of available **doors**, clear or solid style, locking or non-locking. Contact your Metro representative for more information.

Door handle detail is GMP compliant and can be accented with choice of 8 available colors.

Starsys Doors, available in multiple heights, can be specified with or without window, as well as locking and non-locking.

5" polyurethane plate casters, two with brakes, make unit easy to maneuver in tight lab spaces. Other caster options are shown below.

Note: The Starsys System features advanced polymer materials that offer **excellent chemical resistance**. To obtain a complete **Starsys chemical resistance report**, please contact your local Metro representative.

CARTS

A complete system

of enclosed carts is available — in short or tall, narrow or wide, polymer, wire or mixed configurations. You can create the exact cart to meet your exact needs.

Because the components are interchangeable, they can support a high degree of change. And have the reliability to support your needs over the long haul.



MOBILE WORKCENTERS

CARTS

TALL UNITS

STATIONARY WORKCENTERS

ACCESSORIES

OPEN STARSYS



SXSUDOSE



SXSBED



SXSLAP



SXS BIO



SXDGS4



The convenient overbridge can be fitted with a wide selection of baskets, shelves, and bins to keep necessary items within reach.

Easy to clean advanced polymer material is a marked improvement over traditional metal carts: won't dent, chip, rust, flake or corrode.

Molded ergonomic handle is easy to grip.

Interchangeable 3", 6" and 9" (76, 150 and 230mm) drawers with removable totes can be fully extended for easy access.

Side storage allows easy customization of a wide variety of accessories from trash can and Sharps container to storage bins and shelves.

Label holders available to quickly identify drawer contents.

Swing-out Side Storage units increase work surface up to 135%.

Color-coded drawer pulls are available in an array of choices to fit any system or decor.

5" (127mm) polyurethane casters with easily accessed toe brake make for easy rolling.

G R E A T E R S E C U R I T Y



Passive security is provided by security seals which provide the visual assurance that the cart's contents have not been compromised.



Cart security can be maintained manually with key locks, allowing only authorized personnel access to drawers. Key lock allows for key alike/different scenarios and features a removable core to allow security updates.



Optional touchpad-operated security system electronically unlocks the cart drawers without keys. Programmable features include access code, and user-defined time intervals for automatic locking and tamper resistance.



For an added level of security, this locking drawer assembly is available in 3", 6" and 9" (76, 150 and 230mm) heights.

TALL UNITS



As always,
the **Starsys System** lets you
customize and modify any cart to
meet your **special requirements**.

Sized to meet your needs —
short, tall and in **three widths** —
you can virtually be assured of
the right solution. When in doubt,
just contact a Metro Professional.



SXD72TU5



SXD72TU5



SXS72TU2



SXD72TU3



SXDGS1



SXTGS2



SXSGS2



SXSGS1



SXD76CM3
(shown open and closed)

STATIONARY WORKCENTERS



Starsys WorkCenters are designed to be reconfigured. Modular components — doors, drawers, adjustable shelves, full extension shelves, even colors and accessories, can be interchanged to create a highly adaptable solution. One that works.



SX36WC13



SX36WC12



SX36WC14



SX39WC13



Scientific Equipment & Furniture Association Member



SX36WC2



SX39WC4

Starsys WorkCenter Counter Tops



Slate Blue Laminate Mauve Laminate Jade Laminate Black Epoxy

Note: Requests for Stainless, solid surface, and other top materials can also be accommodated. Please contact your Metro Representative for additional information.



SX39WC8



Note: The Starsys System features advanced polymer materials that offer **excellent chemical resistance**. To obtain a complete **Starsys chemical resistance report**, please contact your local Metro representative.

Note: Limited space prohibits us from listing all preconfiguration units. Please contact your Metro Representative for additional information on the complete line of modules available to create your Starsys WorkCenter System.

ACCESSORIES



Side Storage Units

We've tried to think of practically everything. Even a revolutionary way to gain workspace and create easier access almost out of thin air.

The small unit footprint maximizes storage, yet takes up less floor space. Notice the revolutionary side storage units. They conveniently swing out when needed, then close back into the cart reducing the footprint and providing a handle for maneuverability.



Handy tilt-out bins fitted to side storage units can be prestocked with lab supplies.

Overhead view of how to create 135% more work-top space and gain greater access to storage.

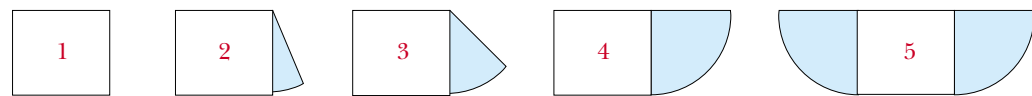

Starsys WorkCenter Counter Tops

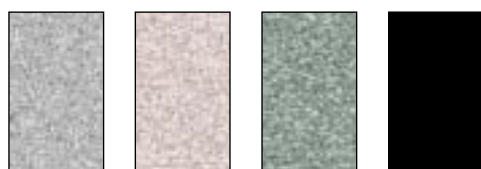

Slate Blue Laminate, Mauve Laminate, Jade Laminate, Black Epoxy

Note: Requests for Stainless, solid surface, and other top materials can also be accommodated. Please contact your Metro Representative for additional information.

Door/Drawer Handles

The design selection includes:



Side Panels

Available in:

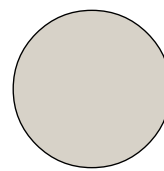

Light Taupe



Wall-mounted overhead cabinets (single- and double-wide) come with choice of clear or solid doors, polymer or wire shelves, and can be easily relocated along wall rail.



Tamour door overhead in a single-wide module can be accessorized using tilt-out bin, shelves, and light.



Cassette storage is ideal for small items, and can be combined with cart or overhead cabinet options (see page 3).



Full extension baskets and totes provide easy access and retrieval.



Overbridge and accessories keep work surface clear of supplies and equipment.



Sloped tops, single and double-wide, are available for wall-mounted and stationary applications.



Roll-up tamour doors and adjustable shelves installed in side storage units allow storage of various size items.



Accessory handle is ergonomically designed to easily maneuver a cart.



Removable drawer totes allow for replenishment system.



Drawers are easily repositioned without tools.



Full extension drawers provide complete access to contents.



Drawer dividers are available to organize your supplies for easy access.



Color-coded drawer pulls are available in an array of choices to fit any system or decor.



Clear doors provide visual access while protecting contents from environment.



Full extension shelves maximize storage capacity.



Polymer shelves are easy to clean and reposition.

OPEN STARSYS

Open Starsys is a modular system available in multiple widths and in high- or low-profile. Fully interchangeable components fit all basic configurations, so carts can be universally applied throughout your entire facility. Storage levels can be height adjusted in minutes without tools and without major disassembly of the cart. And all Starsys units accept most standard-sized tote boxes & bins.



Full-extension shelves—the ultimate density solution



Full-extension storage levels are height adjustable in 1" increments. Glides snap into posts without tools.



Starsys achieves the highest possible storage density within the dimensions of the cube. Wasted space between storage levels is virtually eliminated.



Starsys full-extension shelves pull out for 100% accessibility to materials, improving worker comfort and safety as well as increasing productivity.



APPLICATION IDEAS

Bio Research Labs



Genetic Research Labs



Pharmaceutical Research Labs



Lab Specialty Storage



Test Labs



Commercial Labs



INDUSTRIES SERVED:

- Pharmaceutical Labs
- Biotechnology Labs
- Chemical Labs
- Animal Research Labs
- Forensics Labs
- Polymer/Rubber Labs
- University/College Labs
- Bioterrorism Labs
- Environmental Labs
- Food & Beverage Labs
- Government Research Labs
- School Labs (K-12)
- Contract Research Labs
- Pharmaceutical Labs
- Biotechnology Labs
- Chemical Labs
- Animal Research Labs
- Forensics Labs
- Polymer/Rubber Labs
- University/College Labs
- Bioterrorism Labs
- Environmental Labs
- Food & Beverage Labs
- Government Research Labs
- School Labs (K-12)
- Contract Research Labs



Whether your top priority issues involve storage space, or security, or more efficient transport—our applications specialists can configure a "just right" solution for you and your laboratory environment.

Countertop Materials

We are experienced in designing & detailing countertops in epoxy, laminate, solid surface, hardwood and stainless steel materials.



CAD Modeling

The Starsys System is fully supported by a team of product specialists and CAD designers. All customer configurations are supported with AutoCAD models, drawings and quotations.

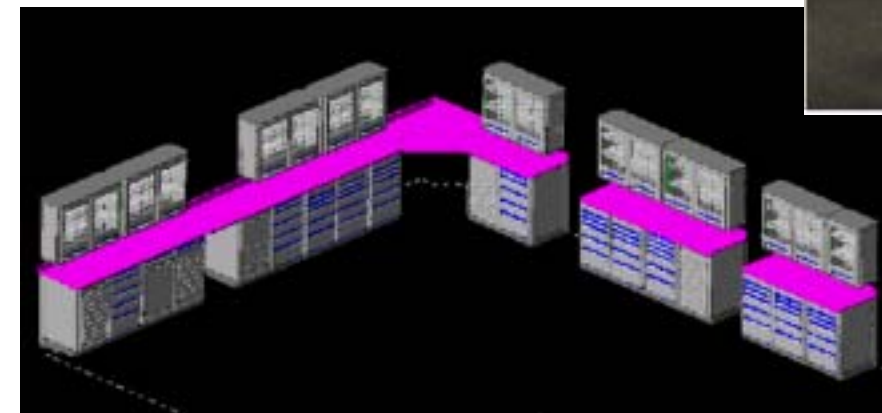
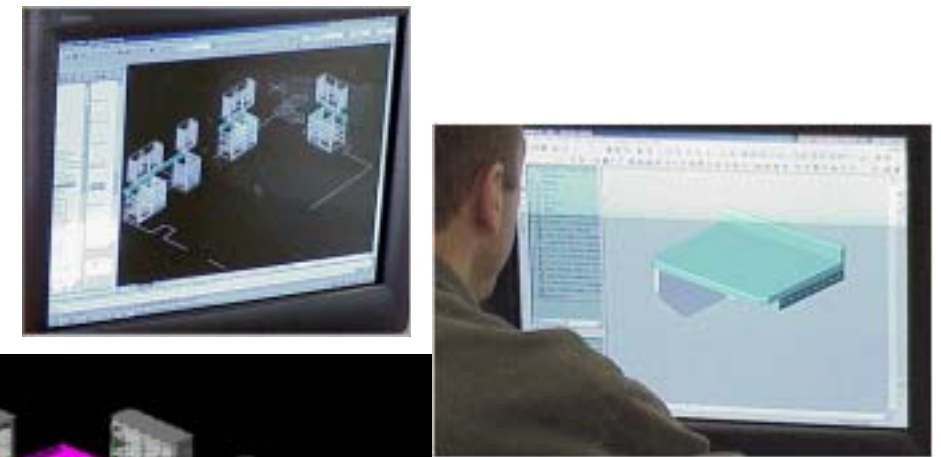

Custom Designs

The Starsys Support team is adept at creating custom design product solutions to address your needs.



METRO VALUE ADDED SOLUTIONS:

Storage and Space Analysis

Metro will provide you with a comprehensive storage and space analysis. We'll make recommendations on how to best use your available space and which solution is right for you.

Drawings/Layouts

Based on our storage and space analysis, we'll provide you with layout and drawing support showing the best solution for your situation.

Quotes

In addition to working with your available space, we also work with your budget. We'll provide you with quotes for the most cost-effective solution.

Professional Sales/Service Consultants

Our sales personnel have a thorough understanding of products, and access to our engineers, industrial designers, and support staff. They can answer any technical questions you might have.



Scientific Equipment & Furniture Association Member



Laboratory Products Association Member



Glassware Cart



High Performance Liquid Chromatography (HPLC) Carts



Mobile Desk



Super Adjustable Super Erecta™

For more information on . . .



Request literature piece L04-100 or log onto www.metro.com



MetroMax® Shelving



Lab Security Cart



LAR Feed Cart (two-tote capacity)



We put space to work.™

InterMetro Industries Corporation
651 North Washington Street, Wilkes-Barre, PA 18705
570-825-2741 • 1-800-433-2232
www.metro.com



© 2004 InterMetro Industries Corporation, Wilkes-Barre, PA 18705
Starsys is a Trademark of InterMetro Industries Corporation.

L03-190A
Rev. 8/04